



**mobi**  
personal transporter

HEAVY-DUTY  
PERSONAL  
TRANSPORTER

## INSTRUCTION GUIDE



COMPLETE BALANCE  
SUPPORT



COMFORTABLE  
TEMPORARY SEAT



HEIGHT ADJUSTABLE



400 POUND  
WEIGHT CAPACITY

**ALL INSTRUCTIONS ENCLOSED MUST  
BE READ, UNDERSTOOD, BEFORE USE.**

walk safely.  
walk in style.

## HEAVY-DUTY PERSONAL TRANSPORTER



### CONTENTS:

Carefully remove the Personal Transporter frame and parts from the box and inspect them for any damage or missing parts that may have resulted from shipping.

Call Juvo Products Customer Service Toll Free: 1.844.277.6191 with any questions..

### PARTS INSIDE BOX:

- (1) Unit (Includes bag, wheels, seat already attached) (see image 1)
- (1) Backrest (see image 2)
- (2) Handles (see Image 3)

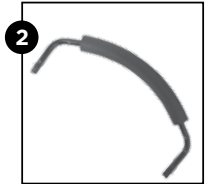

**mobi**  
personal transporter

**ASSEMBLY INSTRUCTIONS:**

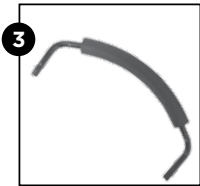

**1. OPEN UNIT**

- Place unit on the floor with top of seat facing up (see image 1).
- Spread frame out, lift up padded seat and press down on bottom of storage bag. User will feel folding bar. Push down on folding bar until it locks in place (see image 2).

**2. INSERT PADDED BACKREST**

- Depress push buttons on the backrest, (image 3) and slide it into plastic backrest hinges, (image 4).
- Make sure that push buttons fully engage in the hinge holes.

**3. ATTACH HANDLES**

- Place handles into the frame (see image 5). Depress push buttons on the handles to allow handles to slide into the frame. Make sure they are the same height.

**4. DETERMINE HANDLE HEIGHT**

- User should stand behind the Personal Transporter with arms hanging at side (see image 6).
- Handles should be even with user's wrist
- Adjust handle height using push buttons on side of handle arms.
- Make sure handle push buttons fully engage in frame holes and handles are at the same height.

**OPERATING INSTRUCTIONS:**

**1. TO OPEN PERSONAL TRANSPORTER**

- Place unit upright on floor.
- Lift up Padded Seat and press down on bottom of Storage Bag. User will feel Folding Bar. Push down on Folding Bar until it locks in place. (see image 7).

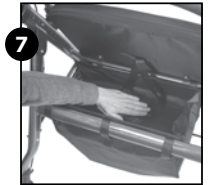

**2. TO CLOSE, FOLD PERSONAL TRANSPORTER**

- Lift up on Padded Seat.
- Lift up on the nylon handle at bottom of Storage Bag. This engages the Folding Bar (see image 8).



**3. BRAKES**

- Squeeze the brakes to stop the Personal Transporter (See image 9).
- Push the brakes straight down to the locking position (see image 10).
- BRAKES MUST BE IN THE LOCKED POSITION WHENEVER SITTING ON THE PERSONAL TRANSPORTER. ALWAYS ENGAGE, DISENGAGE BRAKES SIMULTANEOUSLY.



**4. CHECK HAND BRAKES**

- Hand Brakes should be in working order after assembly.
- Check Hand Brakes periodically for proper function.
- Squeeze the Hand Brakes and check to ensure that the metal brake shoes engage the wheels and stop the Personal Transporter (see image 9, plus 11, 12 next page).

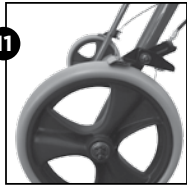

- Push the Hand Brakes DOWN into their locking position and check to ensure that the metal brake shoes engage the wheels and stop the Personal Transporter. (image 10 previous page and images 11 & 12).

## 5. HAND BRAKE ADJUSTMENT

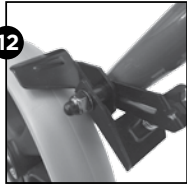

- Hand Brakes should be in working order after assembly.
- However brakes can loosen during normal use.

### TIGHTEN BRAKES

- Place Personal Transporter upright on floor.
- Loosen nut at top of brake shoe assembly, near back wheel. Turn **counter-clockwise** until desired tension is achieved (see image 13).
- Test by squeezing hand brake — ensure that metal brake shoe fully engages the wheel.

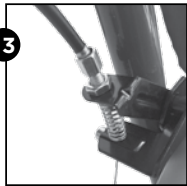

### LOOSEN BRAKES

- Place Personal Transporter upright on floor.
- Loosen nut at top of brake shoe assembly, near wheel. Turn **clockwise** until desired tension is achieved (see image 13).
- Test by squeezing the hand brake to ensure that the metal brake shoe fully engages the wheel.
- Adjust as necessary.

1. READ ALL ASSEMBLY, OPERATING INSTRUCTIONS BEFORE USE
2. Please make sure Personal Transporter is fully opened, seat is down and the Folding Bar under seat is pushed down, locked into position.
3. Make sure all knobs, nuts, bolts are fully tightened. Check regularly to ensure they are secure at all times.
4. Make sure the Personal Transporter is level. Make sure the handles are at the same height.
5. Test the Personal Transporter for stability before applying full weight to hand grips or seat.
6. Test brakes before using.
7. ALWAYS LOCK BRAKES BEFORE SITTING, please refer to Operating Instructions, #3 Brakes and image 10.
8. Replace tires when significantly worn or damaged.
9. Caution: Keep hands clear of frame when folding.
10. Maximum weight capacity 400 lbs.

**Call Juvo Products  
Customer Service  
Toll Free: 1.844.277.6191  
with any questions**

## JUVO PRODUCTS, LLC PERSONAL TRANSPORTER, ROLLATOR LIMITED LIFETIME WARRANTY



Juvo takes great pride in providing products of superior quality, design and function.

This Limited Lifetime Warranty applies to Rollator, Personal Transporter products manufactured by or on behalf of Juvo Products, LLC, (Juvo), under the brand name “Juvo®” or “Mobi™,” and referred to in this Limited Lifetime Warranty as “Product.”

Product is warranted to be free from defects in materials and workmanship for so long as the original owner owns such Product. In the event of any such defect during the warranty period, Juvo® will remedy the defect as described herein, without charge to the purchaser, as soon as practicable. The remedy will consist of repair or replacement of the Product, or refund of the purchase price, at the discretion of Juvo® after opportunity to inspect the alleged defect or photographs thereof. All freight and labor charges will be the responsibility of the purchaser.

This Limited Lifetime Warranty applies to the original owner only and is non-transferable. This Limited Warranty does not cover:

- Labor for any inspection.
- Labor for replacement of any defective item(s).
- Incidental or consequential damages.
- Minor cosmetic defects, which do not affect performance or integrity of a part or the entire Product.
- Non-durable parts that are subject to normal wear and tear, such as Wheels, Hand Grips, Padding, Cables-Brakes, Upholstery, Bag, Plastic Parts.
- Vandalism, improper use, or negligence of the owner.
- Scratches or scrapes to materials or parts, dents, tears in fabric, or other issues that arise out of normal use of the Product.

This Limited Lifetime Warranty applies to Product purchased for personal use only. Product purchased for institutional multi-use environments are excluded from this warranty.

Juvo® Products have been designed for safety and quality. Any modifications made to the original Product could damage the structural integrity of the unit leading to failure and possible injury. Modification of the original Product voids any and all warranties and Juvo® assumes no liability for any modified Products or consequences resulting from failure of a modified Product.

Warranty Claims: The purchaser must notify Juvo directly of any claims under this Limited Lifetime Warranty within seven (7) days following the discovery of the problem. To make a claim under this Limited Lifetime Warranty, the Buyer should contact Juvo Products, LLC at:

**111 North Street, Suite 205  
Barrington, Illinois 60010  
Attention: Customer Service**

**TOLL FREE CUSTOMER SERVICE: 844.277.6191**

A copy of the original purchase receipt should accompany any claim under this Limited Lifetime Warranty.

Juvo shall have no obligations under this Limited Lifetime Warranty if the purchaser fails or refuses to reasonably cooperate in Juvo’s investigation of the claim (such as failing to provide photographs and or written documentation of the claim). If Juvo determines there are defects covered by this Limited Lifetime Warranty, Juvo will have up to thirty (30) days after receipt of notification to process the purchaser’s claim.

This Warranty gives you specific legal rights. You may have other rights as well which vary from state to state or province to province. This warranty excludes all consequential damages, however, some states do not allow the limitation or exclusion of consequential damages and therefore this limitation may not apply to you.



# LIFESTYLE PRODUCTS

that improve mobility and safety  
 around the home



BALANCE &  
 MOBILITY



OPENING



DRESSING



REACHING



SAFETY



TOILETING



BATHING



CARRYING



SURGERY  
 RECOVERY

**mobi** by **Juvo** live actively  
 personal transporter

**SEE ALL JUVO LIFESTYLE PRODUCTS  
 AT [JUVOPRODUCTS.COM](http://JUVOPRODUCTS.COM)**

Made in China



# *mobi*

personal transporter

*by*

*live actively*  
**Juvo**<sup>®</sup>

111 North Street, Suite 205  
Barrington, Illinois 60010

844.277.6191 TOLL FREE

[juvoproducts.com](http://juvoproducts.com)